

TS RERA : P02200005027



AMRUTHA

PROJECTS

Crafted Living



Shambhala

Embrace The Luxury



MASTER PLAN



FLOOR PLAN

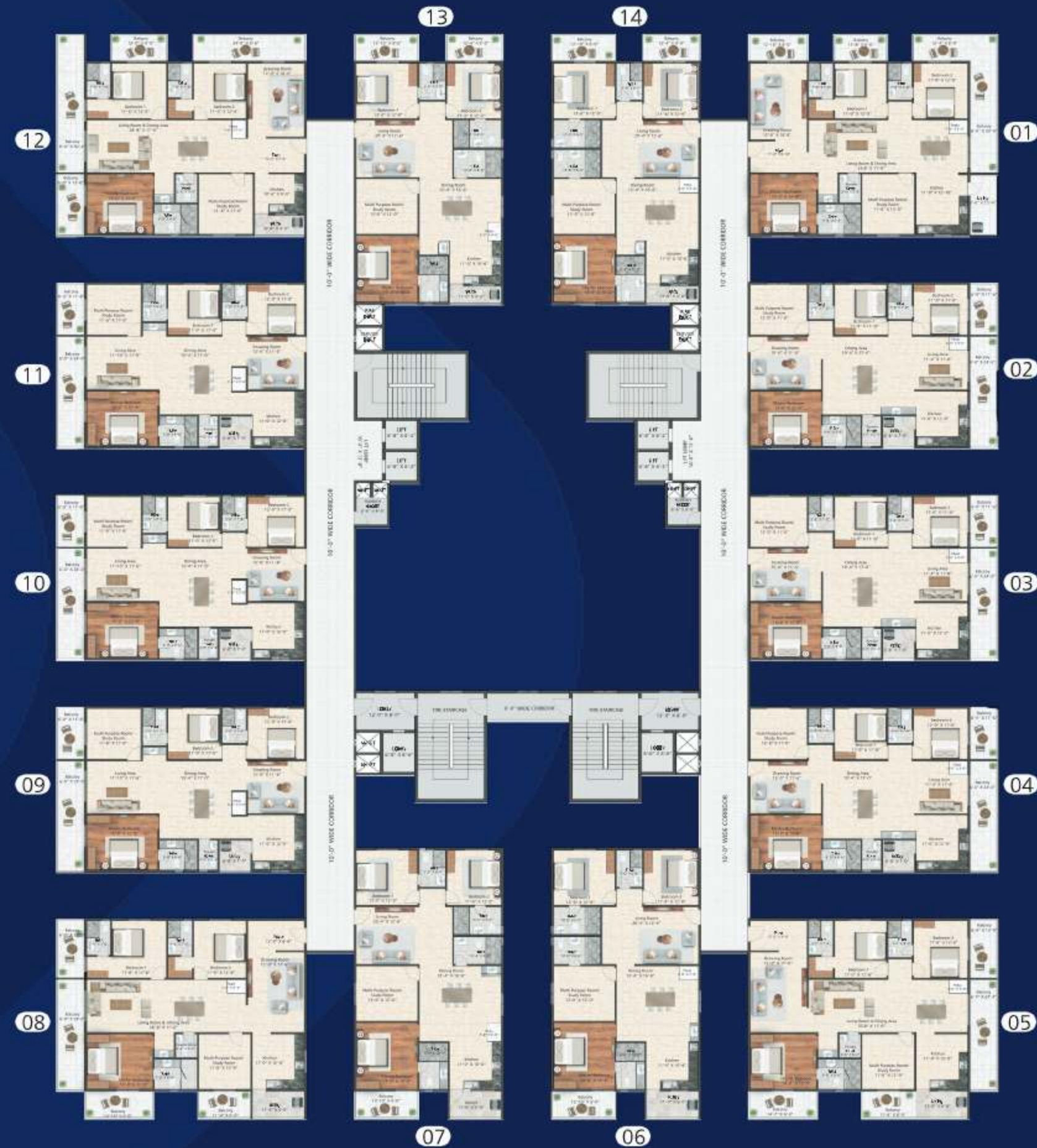

TYPICAL FLOOR PLAN

LEGEND

- 01 Entry/Exit -With Security Cabin
- 02 Arrival Plaza
- 03 Jogging /WalkingTrack
- 04 Informal Seating Area
- 05 Kids Play Area
- 06 Water Body
- 07 Cricket Practice Nets
- 08 Kids Sand Pit
- 09 Elder's Seating Park
- 10 Gazebo
- 11 Toddler's Pool
- 12 Swimming Pool
- 13 Outdoor Gym
- 14 Outdoor Seating
- 15 Entry Ramp to Basement
- 16 Central Courtyard Area
- 17 Batminton Court
- 18 Club House
- 19 Exit Ramp from Basement
- 20 Transformer Area

2.27 Acre's | 12 Floor's | 160 Units | 16,000 Sqft Club House

FLAT NO	01	02	03	04	05	06	07	08	09	10	11	12	13	14
AREA	3170	2665	2665	2665	3100	2550	2550	3100	2665	2665	2665	3170	2560	2560
FACING	WEST	WEST	WEST	WEST	WEST	EAST	WEST	EAST	EAST	EAST	EAST	EAST	WEST	EAST

Specifications

STRUCTURE

- RCC Frame work designed to withstand wind & seismic loads

SUPER STRUCTURE

- All internal walls shall be of "4" thickness and external walls of "6" thickness with Red Brick/AAC Bricks and Cement Mortar.
- Each Floor Height 11 Feet

FLOORING

- Vitrified tiles for flooring with size 4'x2' in Drawing/ Living / Dining /Family Room/ Bed Room.
- Kitchen Cladding with Granite
- Laminated wooden flooring in Master Bedroom.
- Antiskid Vitrified Tiles in Utility and Bathrooms of size 4'x2' and Vitrified tile dadoing up to false ceiling of size 4'x2'.
- Granite flooring in corridors, common area, lift lobby and Italian Marble Flooring in Grand Entrance Lobby.
- Counter top for Wash Basins
- Anti-Skid tiles in Balconies flooring and skirting.

DOORS

- Main Door** - Size of 5'-0" x 8'-0" with Teak Wood (1st Quality) with varnish finish door. Hardware - Brass/SS Hardware with Night Latch, safety chain of superior brands like Doorset or equivalent.
- Internal Door** - Size of 3'-3" x 8'-0" granite frame. Flush Doors with Veneer and Polish.
- Bathroom Door** - Size of 2'-9" x 8'x0" granite frame with Flush Door.

WINDOWS

- Windows** - Size of 5'-0" x 4'-0" UPVC Windows with 3 track of Glass and Mosquito Mesh.
- Ventilators** - UPVC with Glass lowers and Mosquito Proof Exhaust Fan Provision.
- French Door** - UPVC Doors with Sliding Shutters.

ELECTRICALS

- Concealed Copper Wiring with Flame Retardant Low Smoke (FRLS), PVC Insulated wires of superior range like Finolex or Standard Company.
- Modular Switches of superior brand like Legrand/North Star/ Panasonic
- Separate Miniature Circuit Breaker (MCB) will be provided for light & power circuit at main distribution box within each flat.
- Pipe for Air Conditioner in all Bedrooms, Living and Dining.
- Emergency Lighting for the basement, staircase, apartment, lobbies and entrance lobby.
- Sockets circuits for the basement, entrance lobby and parking.
- Generator Back up of 3KVA for each Flat. Master Cut-Off except Refrigerator.
- Automation system provision in flats for Lights, Fans, AC, Curtains and Geyser.(Optional with Extra Charges)
- Automation for Common Areas and Charging Provision for Electric Vehicle in parking .(Optional with Extra Charges)

PAINTING

- 2 Coats of Birla Wall Care Putty with 1 Coat of Paper and 1 Coat of Premium Primer and 2 Coats of Asian Tractor Premium Plastic Emulsion Colour. Similar painting for entire building.
- Front elevation façade with Putty Finish/ Texture. Laving of Cladding Tiles.
- All Doors, windows and Grill finished with Enamel Painting.

KITCHEN

- Black Granite Platform with Granite.
- Stainless Steel Sink with single bowl with drain board.
- Piped Gas connection with gas leakage detector(Optional)
- Panic Button connected to security on ground floor.
- Provision for Aquaguard Point, Telephone Point in Kitchen Area.
- Exhaust Fan Provision.

PLUMBING and DRAINAGE

- Ceramic Ware of premium brand in all bathrooms.
- CP Fittings of premium brand in all bathrooms 3 in 1 Diverter for Shower.
- Superior Quality UPVC/CPVC Piping with special fitting as per relevant IS Specification.
- All plumbing points will be pressure tested in accordance and requirement of the Bureau of Indian Standards.
- Adequate supply of both drinking water and bore water.
- Metered water connection
- Water softener for General Purpose
- Water proof treatment for all wet areas - Bathrooms, Wash Areas, Terrace, Inside OH Tank, Lift Well Pit.

WASTE MANAGEMENT

- Rubbish Shoot's are provided at every floor level and centrally collected for better disposal

LIFTS

- High Speed Automatic Lifts of Reputed make
- One Separate Lift for goods
- Granite/Marble Cladding at all floor levels on the lift front wall.
- High finished interiors in lift.

WTP & STP

- Fully treated water made available through an exclusive water softer
- A sewage treatment plant of adequate capacity as per norms will be provided inside the project .Treated sewage water will be used for the landscaping

FIRE SAFETY

- Fire Stair Case with anti-skid flooring.
- Fire water tank and fire pumps located basement and terrace.
- Pressurized stairs and fire fighting lift
- Fire Hydrant
- Automatic sprinkler system at basement.
- Public Address System
- Portable Fire Extinguishers
- Lighting Arrester for building

TELEPHONE / DATA CONNECTIONS

- TV Outlets in all Bedrooms, Living and Family Room and Telephone point and internet in Master Bedroom and Drawing Room with parallel connection.
- Wi-Fi Points for the entrance lobby and amenity area.
- Direct to Home provision for TV.
- Intercom facility for all flats and to security, Laundry and Amenities.

SECURITY & SURVEILLANCE

- Solar -Powered security fence
- Boom Barrier operated with access card readers
- 24X7 CCTV surveillance

AMENITIES



Yoga



Gym



Jogging Track / Walk way



Cricket Practice Net



Visitor's Parking



Open Air Gym



Swimming pool



Clinic & Pharmacy



Elders seating Area



Children's Play Area



Association Room



Batminton Court

Gym | Creche | Aerobics | Kids Sand Pit Area | Indoor Games(Board Games,Billards & TT)
Ac Guest Rooms | Multi Purpose Hall | Water Body | CCTV 24/7 | Security Cabin | Waste Management
Separate Swimming Pool for Toddler's & Adult's | Central Courtyard | Lawn



Near By Location

Educational Institutes - DRS Public School • Niraj International School • Gitanjali International School
• Malla Reddy University • St Martin's Engineering College • Mahindra University

MNC's - Tech Mahindra

Hospitals - Aashitra Hospital • Ankura Hospital • Renova Hospital • Suraksha Women & Children • Malla Reddy Hospitals

Near BY Landmarks - ORR • Kompally X Road • Shree Convention

Location Map
(Not To Scale)

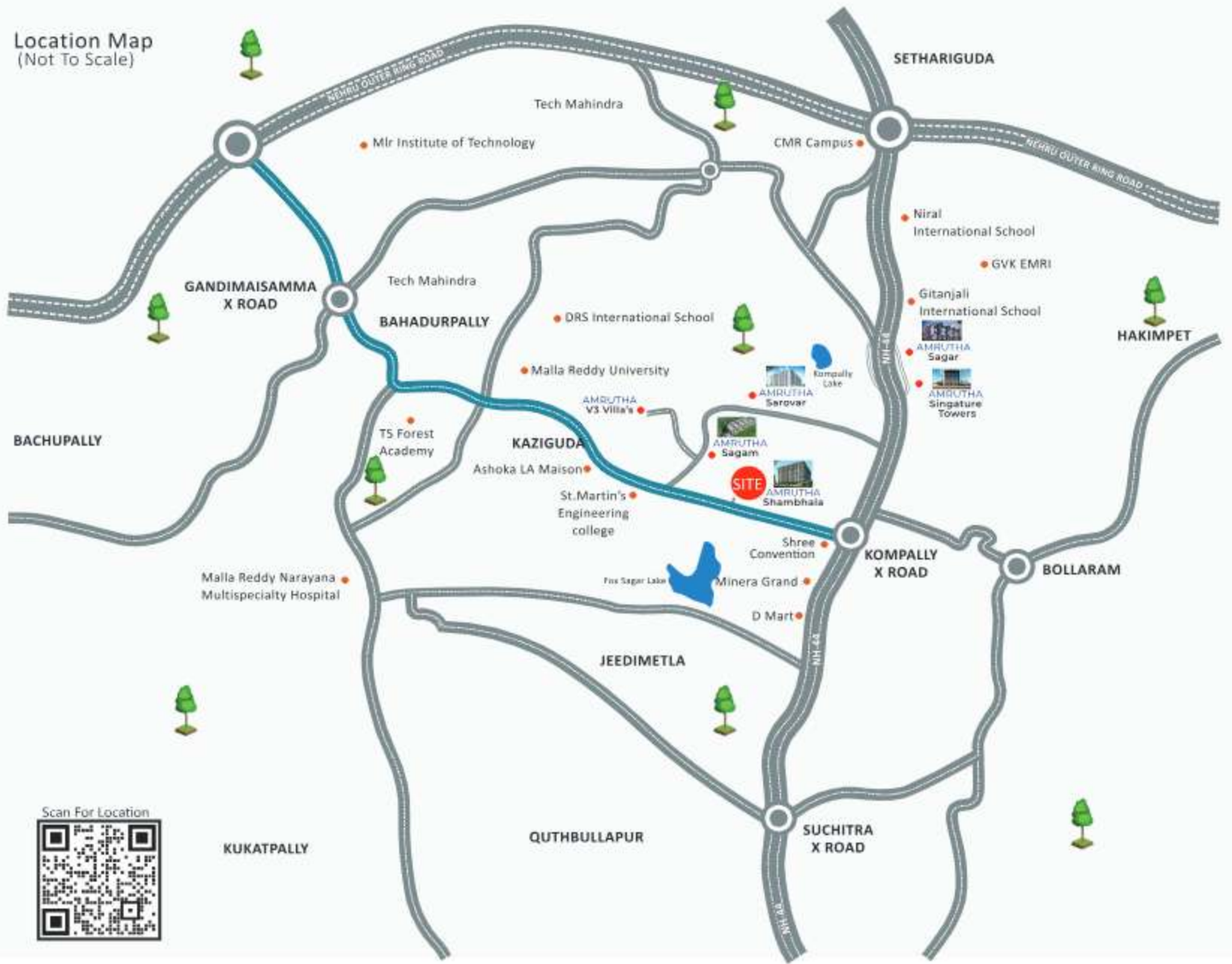

Scan For Location



AMRUTHA
PROJECTS

Crafted Living

Sy.No.180,182/A and 183 Part Kompally Village ,Dundigal
Gandimaisamma Mandal,Medchal-Malkajgiri-500014

www.amruthaprojects.in
sales.amruthaproject@gmail.com
accts.amruthaprojects@gmail.com

+91 9100007182
+91 9100007183



Scan For Website

Note: This trifold is purely conceptual and not a legal offer. Area is tentative and actual areas arrived at completion of the flat may differ. The Promoters reserve the right to make changes in elevation, plans & specifications as deemed fit.